

Certificate of quality

This product has been tested and proved to be qualified for delivery.

Inspected by:

Inspection date:



Version: GMD120-D-EN01

KINGZO[®]

GMD120-D

Electric Film Reeler Manual

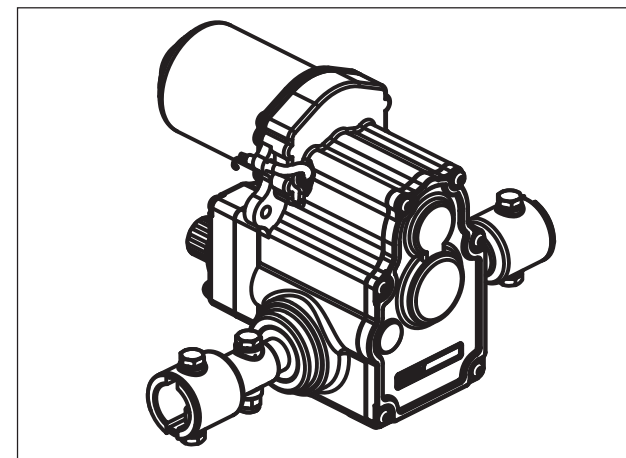

Manufacturer : Beijing Fenglong Greenhouse Technology Co., Ltd.

Address : Chinese Academy of Agricultural Sciences, No.12 South Street,
Zhongguancun, Haidian, Beijing 100081 China

ZIP: 100081

Tel: +86 10-62149667

Fax: +86 10-82108614

Web: www.bflc.com.cn

CERTIFICATE OF PRODUCT QUALITY

Dear Customer:

Our company have obtained ISO 9001 certificate. The Kingzo® electric film reelers are all inspected and each parameter is followed according to our company electric film reelers standards.

We hereby certify that when the film reeler is correctly installed, the guarantee period of the products is 3 years (from the time of purchase). Products with quality problem within the guarantee period would be solved free of charge or replaced.

EXEMPTION CLAUSE: _____

- 1、 Operation against this manual.
 - 2、 Improper usage, maintenance, storage or damage on purpose.
 - 3、 Damages out of unauthorized un-installation, repairment.
 - 4、 Damage by force majeure.
 - 5、 Usage out of rolling ventilation and curtaining.
- _____

8.Wiring Distribution Table

24V120W (GMD120-D)					
Installation Distance Control Mode	30m	50m	75m	100m	150m
Each circuit controls 1 set	2*1.5mm ²	2*2.5mm ²	2*4mm ²	2*4mm ²	2*6mm ²
Each circuit controls 2 sets	2*4mm ²	2*4mm ²	2*6mm ²	2*10mm ²	2*16mm ²
Each circuit controls 3 sets	2*4mm ²	2*6mm ²	2*10mm ²	2*16mm ²	2*16mm ²
Each circuit controls 4 sets	2*6mm ²	2*10mm ²	2*16mm ²	2*16mm ²	2*25mm ²
Notice: Wire is the standard copper one.					

Dear Customers,

We are grateful for your continuous trust and support over the decades. We will do our best to continue the all-round service and quality products.

Beijing Fenglong is a high-tech company with high R&D investment, supplying equipments ranging from modern greenhouses to livestock houses. Feng long has been leading the trends of mecho-electro products in Chinese facility agriculture.

Fenglong established and follows strict quality control and follow-up systems. Fenglong obtains ISO9001, ISO14001 and OHSAS18001 certificates, ensuring all the products are qualified with possibility to track them down.

CONTENTS:

1.Safey tips-----	1
2.Product features & performance data -----	2
3.Installation Instructions -----	4
4.Limit range adjusting-----	7
5.Maintenance -----	8
6.Common problems & solutions -----	9
7.Packing list -----	9
8.Wiring distribution table-----	10
9. Certificate of product quality-----	11

The product is subject to design and performance modification, it could be a little different from this Manual. But it will not affect your usage. This Manual is also subject to modification without further notice. Please read this Manual carefully before using the product.

No.	Problem	Analysis
1	Motor doesn' t rotate	No power connection
		The left and the right knob touch the micro switch at the same time.
2	Limit not accurate	Lock bolts loose
		Inner parts damage
3	Noise	Incorrect installation
		Overload

7.GMD120-D Packing list

No	PART NAME	QTY	MARK
1	Electric Film Reeler body	1	
2	Coupling	2	
3	Suit	2	
4	Plugs	2	
5	Self-locking nut M8	2	
6	Hexagon bolt M8×12	4	
7	Hexagon bolt M8×45	2	
8	Assemble instruction	1	

- 1.The packing list only contain the standard accessories and documents, it doesn't include the other accessories you choose. If you have ordered other accessories, please check it when you receive the order. The production date is on this packing list.
- 2.To insure your interest and rights please keep this packing list for future service.

- 4.2.4 When the motor is rolling up the plastics, the pipe arrives at the required position, at this time rotate the knob which controls the rolling status and make the gear pin touch the micro switch(with click sound), hold on and fasten the lock bolt by a cross head screw-driver.
- 4.2.5 When the motor is rolling down the plastics, the pipe arrives at the required position, at this time rotate the knob which controls the rolling status and make the gear pin touch the micro switch(with click sound) , hold on and fasten the lock bolt by a cross head screw-driver.
- 4.2.6 The above steps would set up the motor's limit range. Turn on the power and check if the range setup is correct. If it is not correct, please review the manual carefully and do the setup again.

5. Maintenance

- 5.1 Check the bolts on each connection regularly. Replace the bolts which is deformed or snapped.
- 5.2 No need to refill the gear oil during the life duration of this product.
- 5.3 This product could be used for greenhouse rolling ventilation and curtaining system. For other usage, please consult our company first.

6. Common problems and solutions

1、 Safty tips

- 1.1 The life of this roll-up would be extended by proper operation and maintenance, please kindly operate according to this manual strictly.
- 1.2 This product needs DC24V input currency. Specialist or electrician is needed to connect the power. Please don't connect \ AC220V or any other unspecified power, or there would be damage or fires.
- 1.3 When the rolling pipe is rolling to high position with the plastics, please don't loosen this product with the pipe. Or the rolling pipe will fall down fast and there would be possibility to hit person or to cause damage to the product.
- 1.4 Cut off the electricity when there is lightning or the motor could be damaged.
- 1.5 The rolling pipe could be at the same line with the motor shaft. The curve of the pipe should not be too big, or the motor could be damaged by overload.
- 1.6 Please check and fasten the bolts connecting the electric winch and its accessories; loose bolts will cause danger.
- 1.7 If the product didn't work , please don't uninstall the part inside; you should stop operating and contact the distributors or the company.
- 1.8 Please don't put the product into water and store it in moist environment; the product could be damaged or cause danger to operators. If the products have water leaking inside, please stop operating and send it back to the factory for repair.
- 1.9 Please don't toss or throw the products, it should be prevented from outside force.

- 1.10 The user should keep the site clean and swipe the leaves or snow on the plastics to avoid overload damage.
- 1.11 After the adjust is finished, the user should fasten the bolts or there might be damage or accidents.
- 1.12 Don't use the product over the maximum currency.
- 1.13 In the transportation or in installation please prevent the products from falling; tossing the cable is prohibited.
- 1.14 We are not responsible for the damage due to ignorance of our instruction manual.

2、Product Features and Performance data

2.1 Product Features

This product is compact in structure, reliable in performance, convenient in installation and operation, adjustable reversing switch, with reversing-lock function;

2.2 Outside Drawing

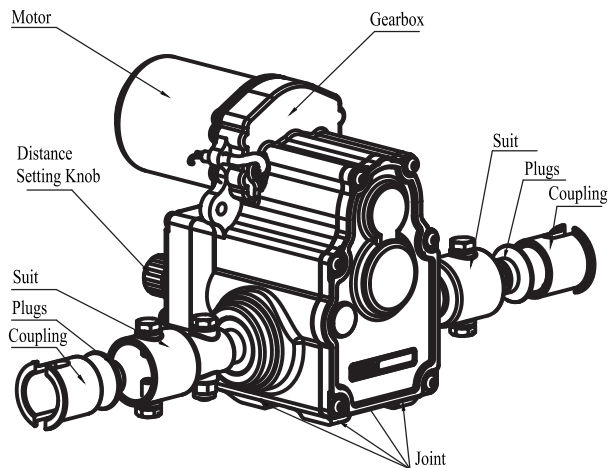

4、Limit range adjusting

4.1 Limit illustration

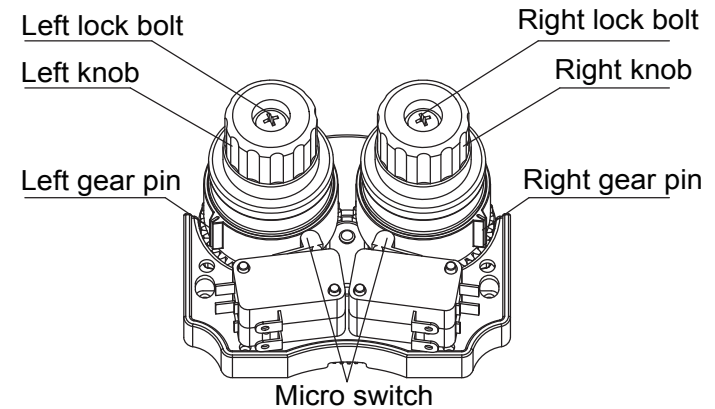

Before limit adjust, please loosen "left or right fasten bolts"
After limit adjust, please fasten "left or right fasten bolts"

CAUTION: After the limit adjust is finished, please fasten the bolts. Or the limit will not be accurate and there would be danger of power shock.

4.2 Limit switch adjusting

- 4.2.1 Loosen the left and right lock bolts by a cross head screw-driver, at the same make sure the gear pins don't touch the micro switch.
- 4.2.2 Turn on the power, and make the motor run, confirm the status of the rolling pipe, is it rolling up or rolling down.
- 4.2.3 When the motor is rolling up the plastics, rotate any of the knobs slowly, and make the gear pin touch the micro switch (with click sound) , if the motor stops running, it means this knob is used for the rolling you need; if the motor doesn't stop running, then the other knob is used to control the required rolling.

3.4 Installation diagram.

Figure 1

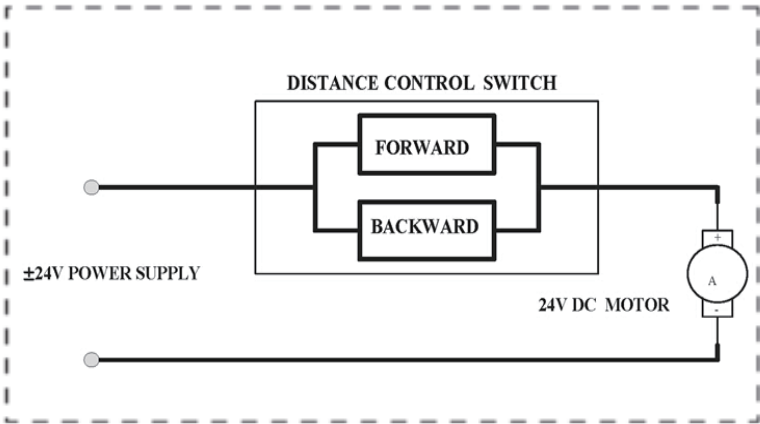
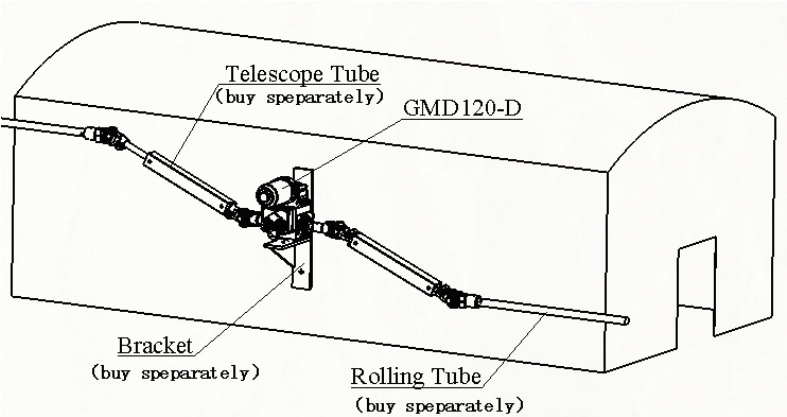
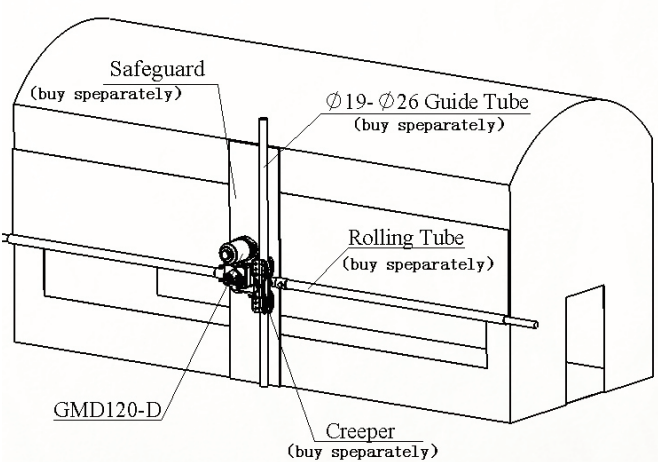
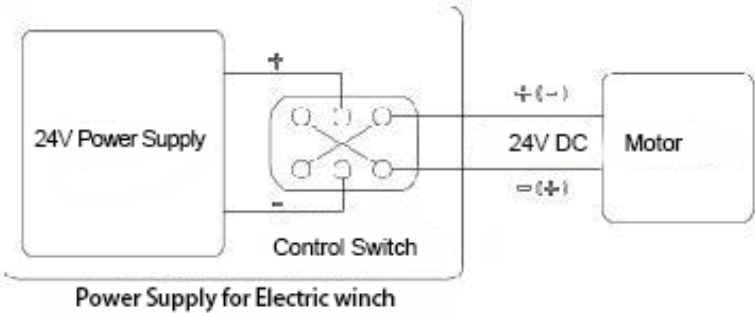

Figure 2



Connecting Diagram



3.4.1 Please operate this product according to the “correct installation diagram”.

3.4.2 Correct installation could guarantee the performance of the products.

3.4.3 After the installation, the motor should be above the limit switch at any position of the rolling.

2.4 Performance data

Model	GMD120-D	
Power	120W	
Torque	140N • m	
Current	≤7.5A	
Voltage	DC24V ± 3V	
Speed	70N • m	3.2 r/min
	140N • m	2.7 r/min
Rolling tube	3/4" (OD: Φ27) or 1" (OD: Φ33.5)	
Recommended Load	Rotating ability	Screening
	180m(L) x 1.5m(H)	700 m²
Maximum range (output shaft)	38 Rounds	
Protection degree	IP55	

3、Installation instructions

3.1 First please fasten the pipe and this product with the bolts.

Then fix the film into the pipe by the film hoop, please keep the pipe and the output shaft of this product on the same line; then start the motor and operate the opening and closing the films.

3.2 Two types of pipe could be used for this motor, the diameter is $\phi 27$, $\phi 33.5$. When the $\phi 27$ pipe is used, the suit is needed, the $\phi 33.5$ pipe doesn't need it.

3.3 The pipe for top opening is $\phi 27$.

3.4.4 After the installation, the cable should be connect into the control box, then turn on the power, adjust the limit switch the proper position, and then fasten the lock bolts.

3.4.5 If there is power failure during the operation of the products, and you would like to lower down the rolling pipe urgently, you could hold the pipe first and loosen the connection between the pipe and the motor, then lower the pipe slowly.

3.5 Installation dimension

